

*Jig*

# PORTFOLIO

ບ່ອນສະສົມ

2026

Hello, I'm Ji Jie, a product design student at Rangsit University.  
My design practice focuses on reconstructing emotional belonging within time-scarce and space-limited urban contexts.  
I believe design is a silent dialogue between people and objects, rooted in deep observation, intentionality, and emotional resonance.  
My work pursues material honesty, gentle interactions, and calm expressions, spanning furniture, homeware, and lighting design.  
I aim to create clear, purpose-driven design that responds to real life—not just aesthetics.

JI JIE

Designing Quiet Systems for Urban Life



## Contact

Jie04.Season@Gmail.com

+66 81 963 5035

Instagram : Seasonnakub

## Logiciels



## Experiences

### 2022 | Rangsit University

Research & Project: Modeling and Design Application in Campus Products

### 2025 | YAAF Design

Furniture Design, 3D Modeling and Rendering, and On-Site Supervision, Material Development & Prototyping

### 2026 | Freelance

Watch case modeling and CNC machining, watch dial design and printing, watch restoration and polishing

## Technical Skills

Product Photography

Woodcraft & Furniture Workshop

3D Printing | Ceramic Craft

Watch Case Design Modeling & CNC Machining

Watch Assembly and Manufacturing



01/  
Pour Kettle



02/  
Nexus Lamp



03/  
Joint Chair



04/  
Nest Sofa

01/

# Pour Kettle

Minimal constant-temperature kettle for busy office workers





Urban morning routines are fragmented into micro-actions, leading to the loss of ritual, continuity, and emotional grounding.

Minimalist constant-temperature kettle for busy urban workers  
Urban professionals do not lack breakfast—they lack time, continuity, and emotional grounding.

A survey of 2,000 adults (The Sun) shows 47% spend 10 minutes or less on breakfast, and 40% eat on the go, with Generation Z being the most affected.

## Use Scenario



7:00

Wake up  
rushed



7:20

Go out  
distracted



7:30

Chasing transportation  
anxious



7:50

Breakfast time (Skip)  
incomplete

## How might we design a calm daily ritual within a 5-minute morning routine?

System includes:

- temperature control kettle
- quick meal preparation
- simplified interaction

The product is not an object, but a trigger for restoring daily rhythm.

Pen tips are the most common items found in an office. Drawing inspiration from their shape, we simplified the design and chose the simplest, most practical colors.



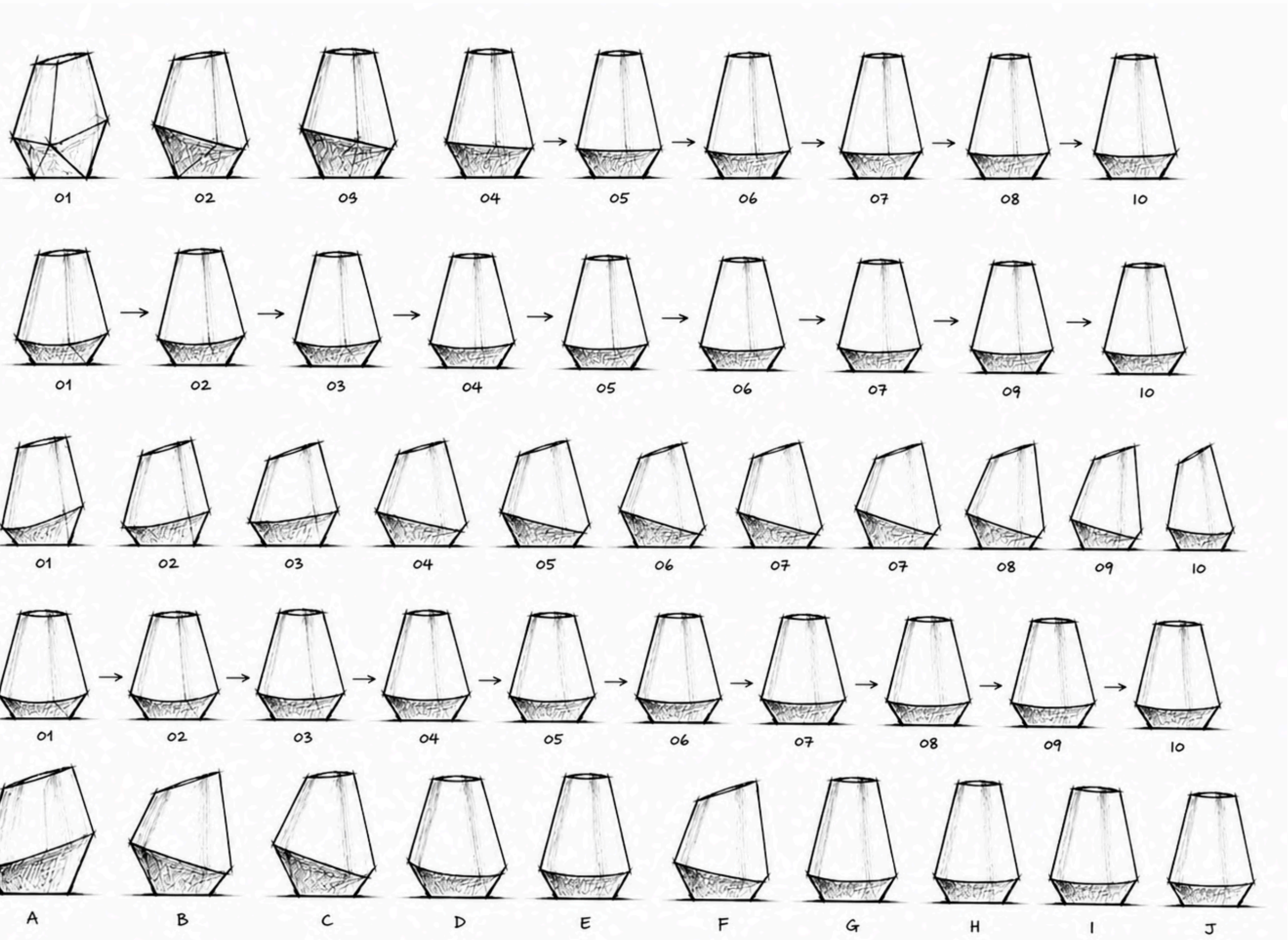

Processing of sketches



## Housing Material

CNC-machined housing made from 6061/6063 aluminum alloy

- Lightweight, easy to CNC machine, and simple to finish (satin, anodized, sandblasted)
- Food-grade safety, suitable for applications involving contact with drinking water
- Can be manufactured as either a one-piece hollow CNC housing or a double-layer insulated structure

# How to use it?

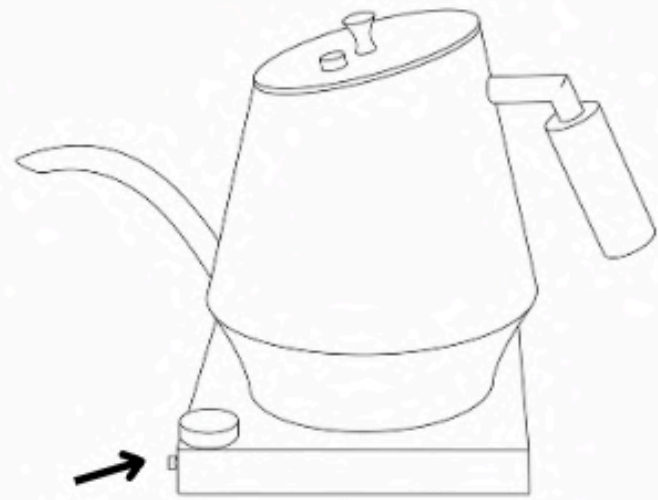

01/

Power on upon  
arriving at the office

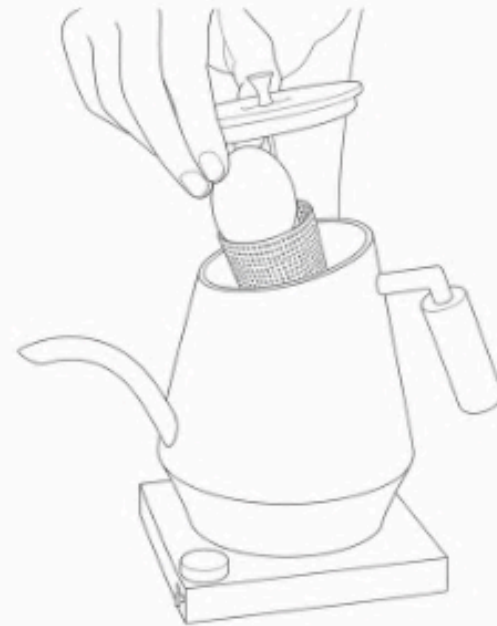

02/

Functional logic:

- One-handed operation
- Pre-set temperature modes
- Minimal steps ( $\leq 3$  actions)



03/

Adjust temperature via the  
knob and wait for heating



## Processing

First, the component is machined using CNC, then sanded, polished, and stained. However, it is not polished after staining, as a matte finish is more suitable for an office setting and offers a better texture.

## Polishing the details



Turn on the switch and turn the knob to set your desired temperature. The temperature control feature allows you to cook simple meals and brew tea or coffee.

Minimalist design and simple colors, the easiest way to use it, and the simplest way to *save time*.

## A design tailored for office workers

This design helps urban users save time while regaining a sense of daily ritual.

It supports fast, healthy breakfast preparation in 1–2 minutes, providing essential protein, vitamins, and warm drinks for daily work

By preparing a quick and easy breakfast, working professionals can save time—in just a minute or two each day, they can get essential protein and vitamins, as well as the coffee and tea they need most in their daily lives.

This project shifted my perspective from designing objects to designing temporal experiences.

I began to see design not as a solution, but as a way to reconstruct fragmented everyday life.



02/

# Nexus Lamp

Light is not illumination—it is emotional infrastructure for displaced individuals





## Pain Points and Sources of Inspiration

Contemporary Chinese immigrants in the UK frequently inhabit compact rental units, where spatial constraints and limited daylight exposure intensify experiences of isolation and emotional stress.

- Nearly 10% of the UK population is foreign-born (ONS, 2021).
- Many new immigrants live in studios and one-bed flats, often lacking sufficient natural light.
- London receives < 8 hours of daylight in winter, contributing to reduced psychological resilience.
- 1 in 6 adults experiences mental-health challenges weekly (Priory, 2023).

Lighting thus becomes not only a functional necessity, but an environmental factor shaping emotional well-being.



The visual rhythm of **railroad tracks**—parallel lines, junctions, and repetition—reflects patterns of movement, departure, and return.

For many Chinese immigrants, these structures become symbolic markers of origin, transition, and homecoming.

The motif informs the structural logic of the modular lamp: linear paths, branching joints, and modular intersections.

# Modular/Magnetic

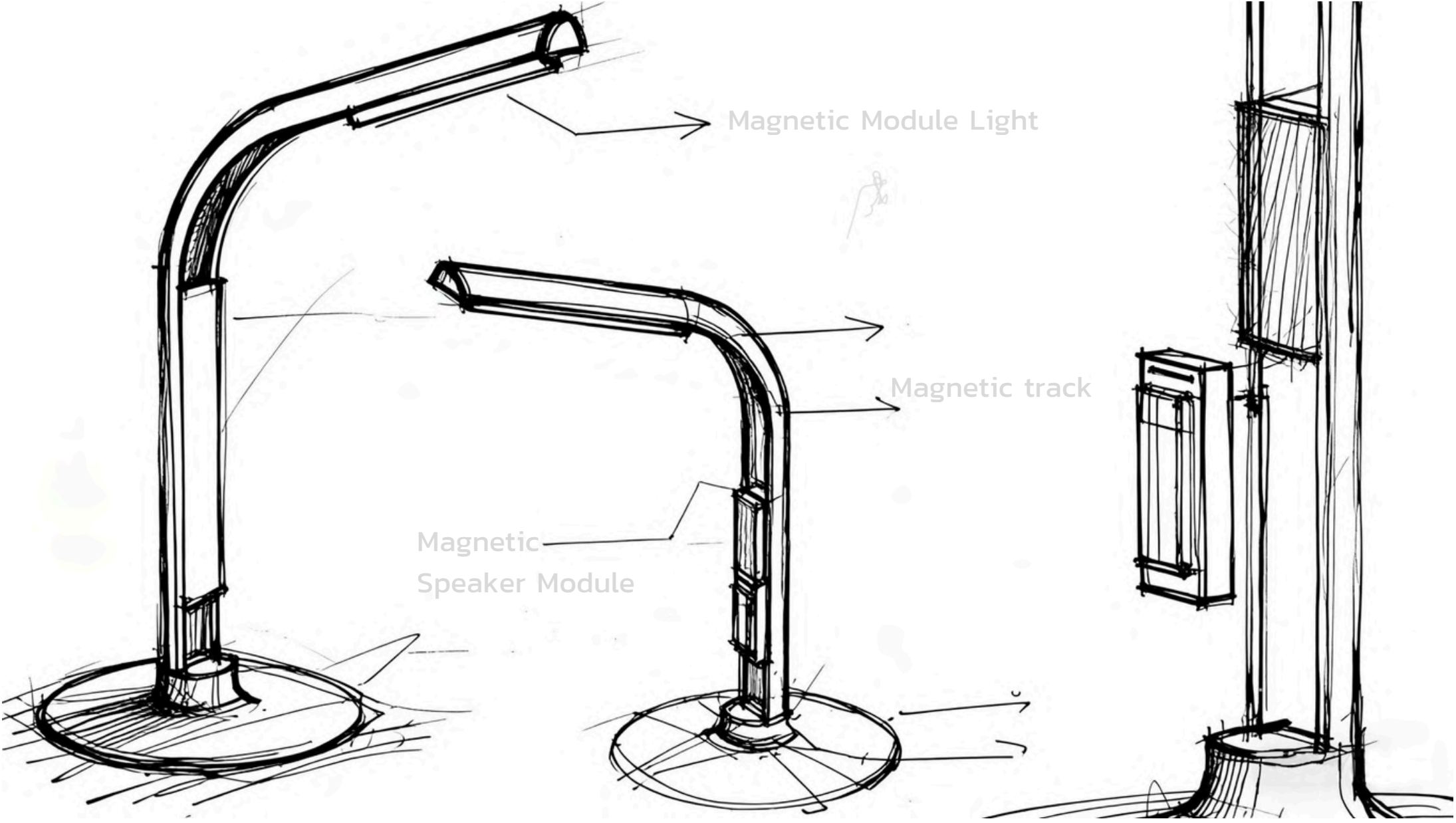

Light is not illumination—it is emotional infrastructure for displaced individuals

The sliding track can be freely repositioned—it's entirely up to the user. The magnetic attachment and power supply make it simple and safe to use. When to use it, where to use it, and what to use it with—it's all up to the user.

# Use Scenario

Urban users operate under fluctuating conditions of time pressure, cognitive load, and emotional instability. Rather than offering a fixed function, the system is designed to adapt through adjustable interaction intensity.



Homesickness



Feel boring/emotional

Turn on light and music

Turn on soft light/music/ fragrance



Feel sad/anxious

Turn on light and fragrance



This is a modular ambient lamp designed to bring warmth, flexibility, and emotional comfort into compact living spaces.



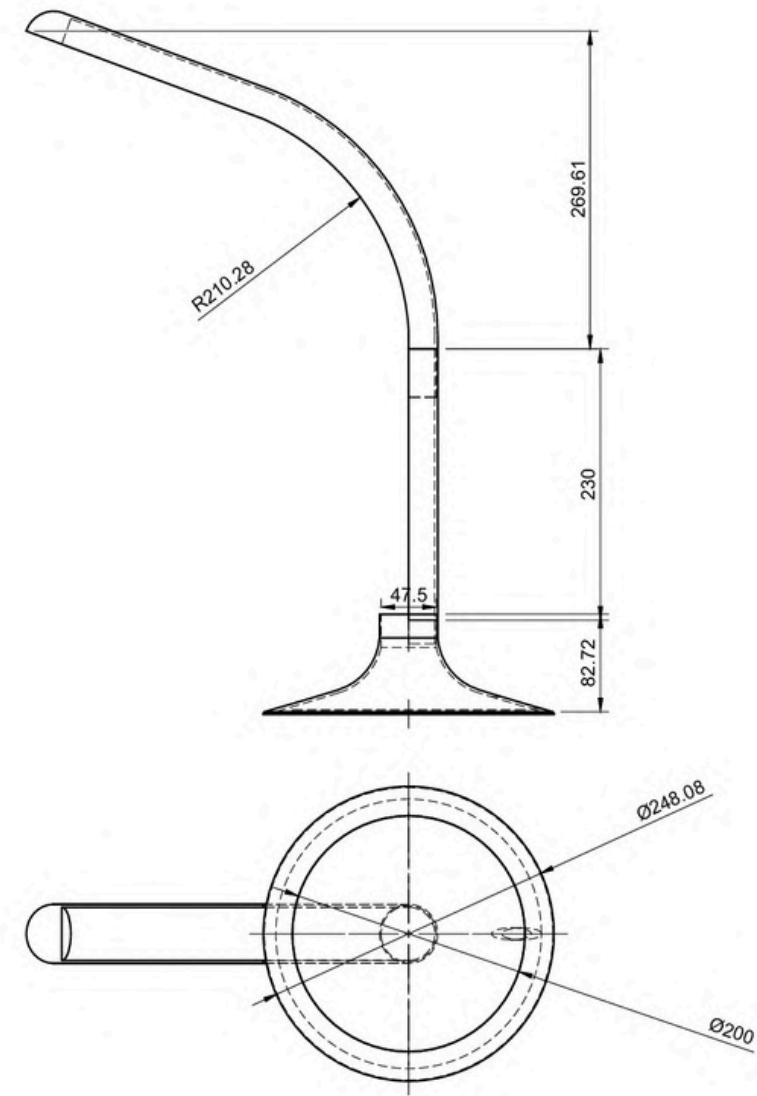
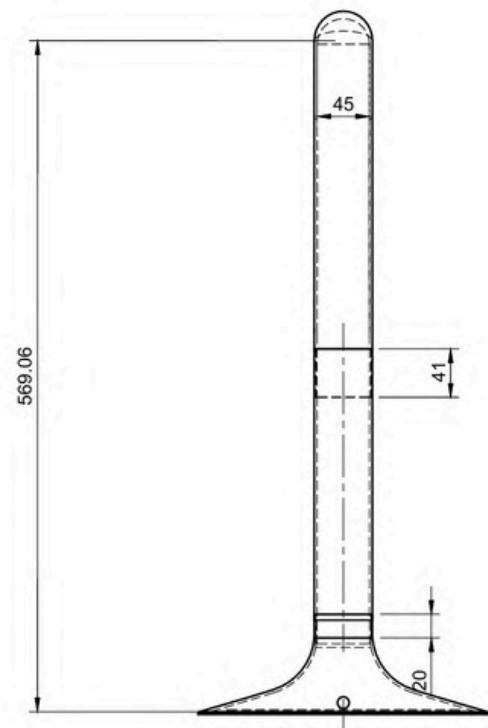

## Size adjustment

Industrial-grade 3D printer using Resin 9400, a material known for its excellent workability, high strength, and ability to produce intricate details.



After printing a 1/10-scale miniature model and finding that it stood stably, we proceeded to print it using a large industrial-grade printer.



## Production Process

After printing the product, I sanded and applied putty. After several rounds of sanding and puttying, I applied the paint. I chose “Clay White” for the color—it’s softer and more inviting than pure white, and its gentle, bright hue can greatly help soothe the mind.

## Use Cases

Perfect for everyday settings like your desk at home or at the office, and great for helping to ease stress

With its modern yet minimalist design, the slightly rough surfaces add a touch of warmth, making it feel more at home in real-life settings and creating a cozy atmosphere for users.



03/

# Joint Chair

A minimalist wooden armchair defined by Chinese character, and balanced contrast.



# Concept & Design Intent

The goal was to create a minimalist, modular dining chair that balances functional simplicity with visual warmth, drawing inspiration from Nordic and Japanese design principles.

- Core Keywords: Minimalism, modular construction, single-piece bent wood armrest, exposed structural joints, and a light, airy silhouette.
- Functional Focus: To prioritize both comfort and durability, while reducing unnecessary components and visual clutter.
- Key Feature: The continuous armrest-backrest design serves a dual purpose, acting as both support and a unifying visual element to simplify the overall form.



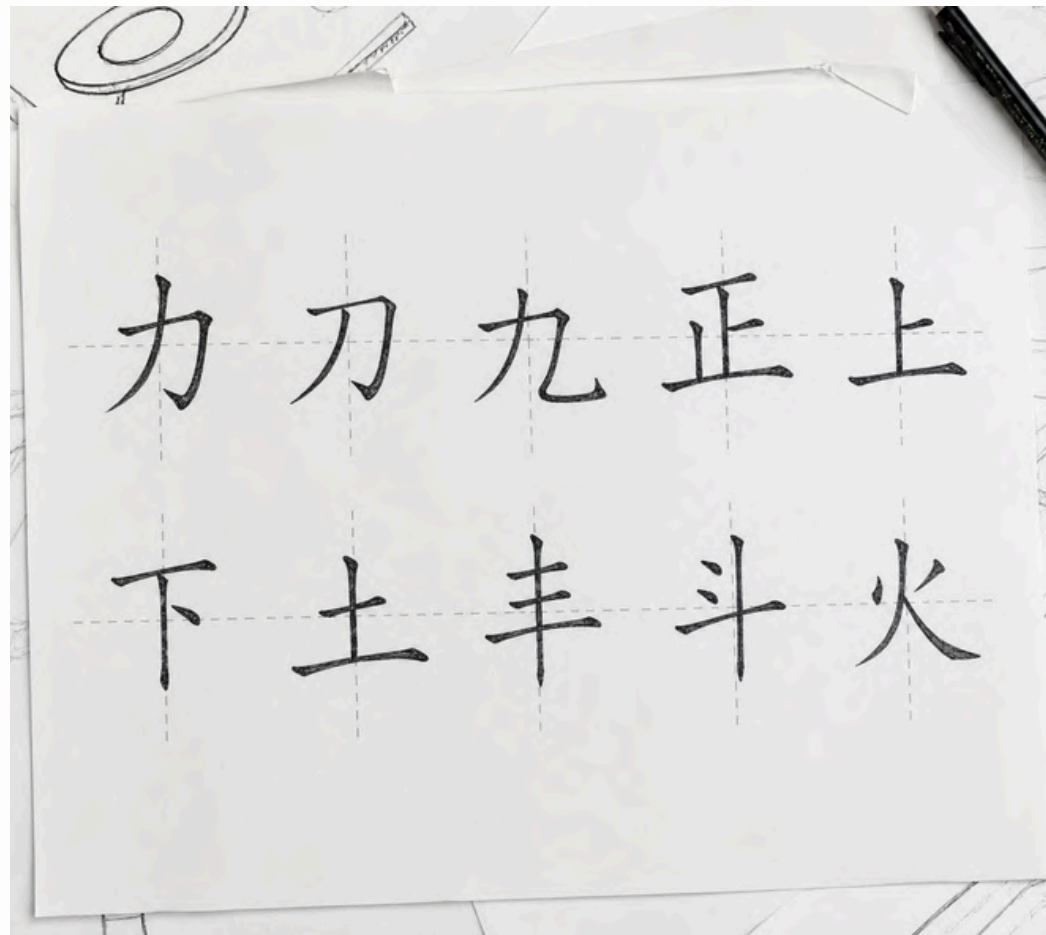

Structure as a carrier of cultural logic, rather than decoration

Product processing

I draw inspiration from structure; some of them have very interesting shapes. I've noticed that while some characters have very simple structures, they still manage to hold the whole together.

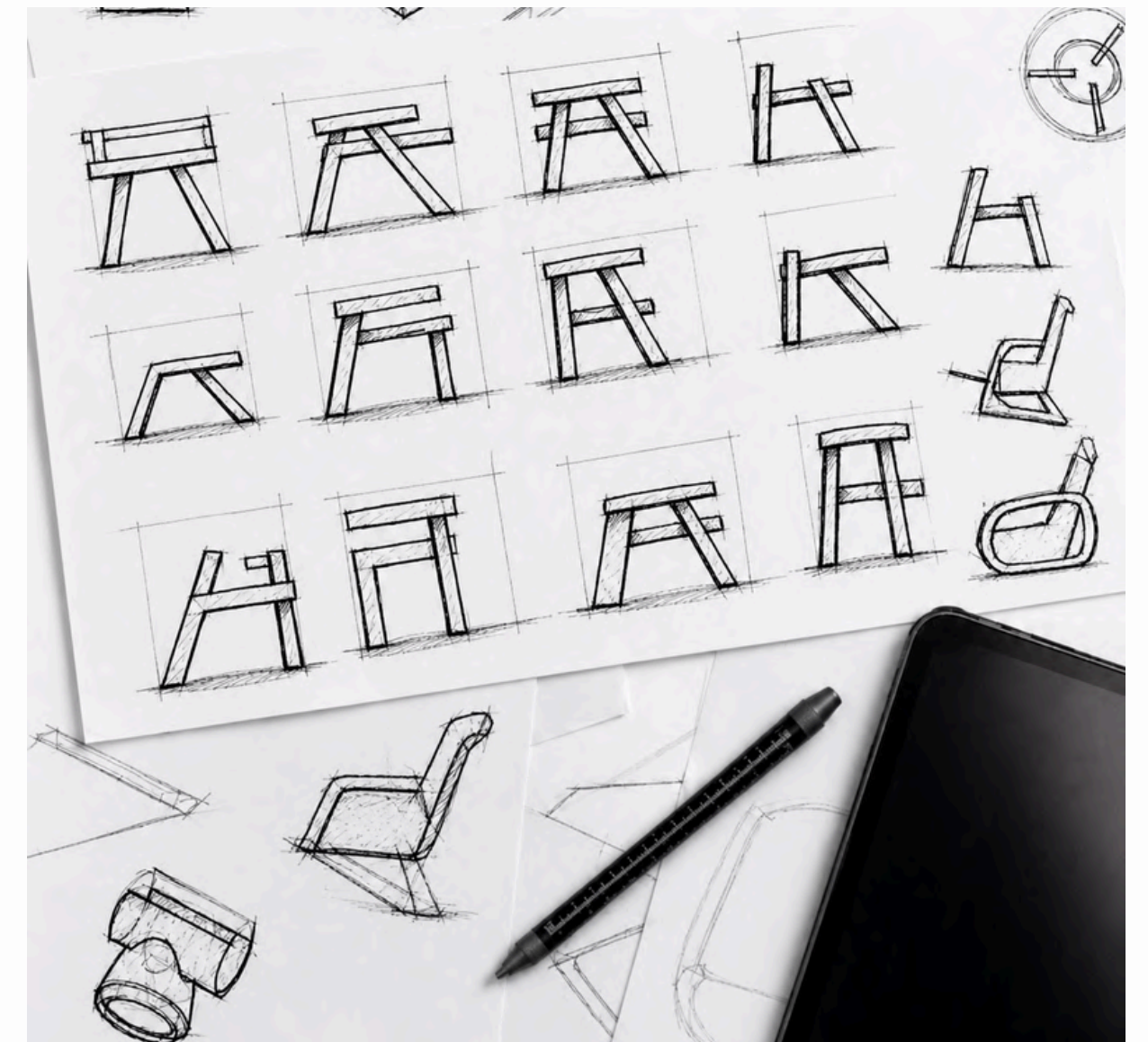

# Joint Chair

Structural simplicity can carry cultural identity without ornament, the Joint Chair features a solid dark wood frame, iconic curved armrest, and a light upholstered seat. Exposed joinery details celebrate the craft of connection, while the clean silhouette and neutral palette fit seamlessly into modern, minimalist interiors

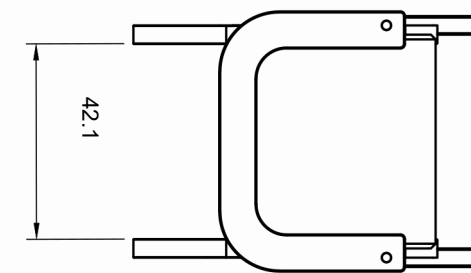
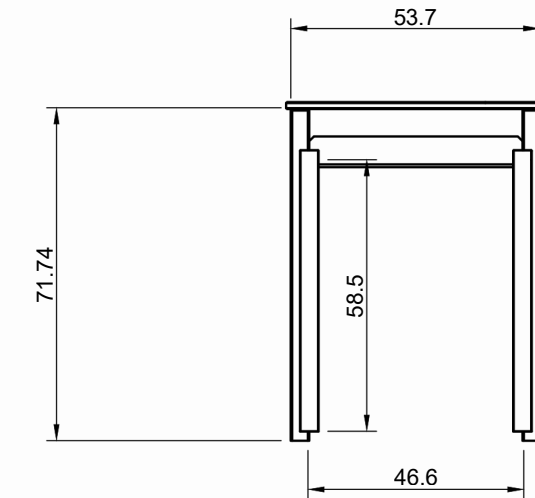
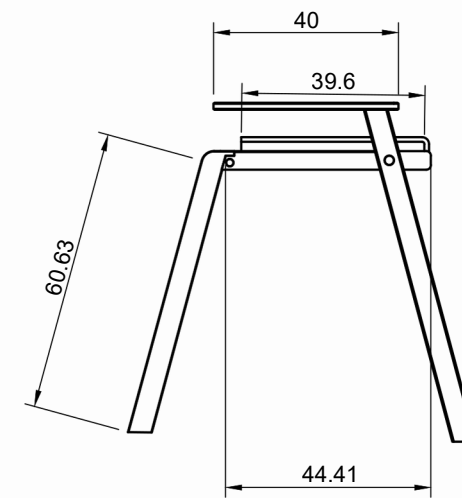



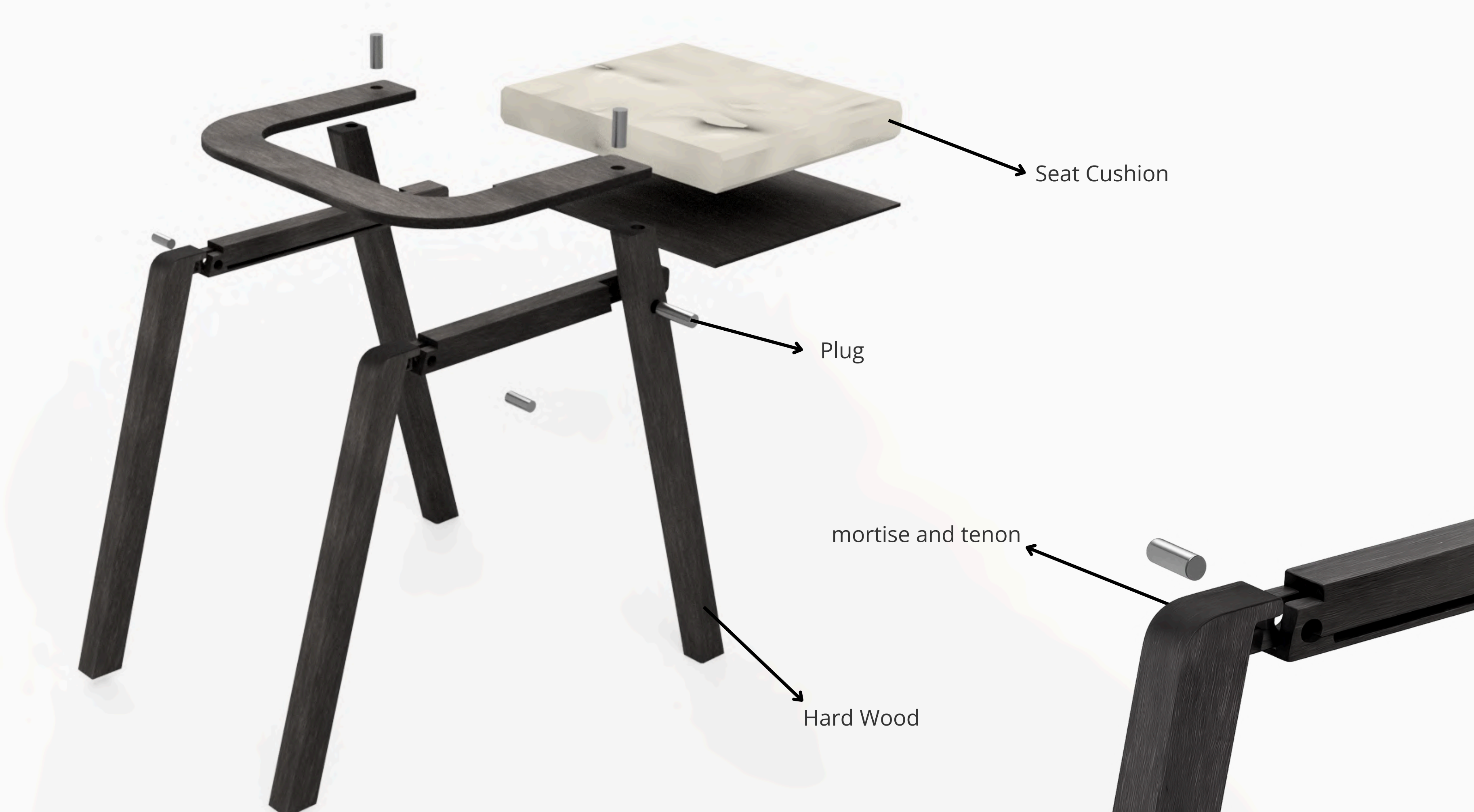

Seat Cushion

Plug

mortise and tenon

Hard Wood

# Joint Chair

The wooden structure facilitates transportation, and the mortise and tenon joints make assembly easy. Suitable for living rooms and cafes, its simple structure embodies minimalism.





## Joint Chair

A study in functional minimalism, this chair reimagines the classic dining armchair with a bold, streamlined silhouette. The continuous U-shaped armrest doubles as a low backrest, offering subtle support while defining the chair's clean, geometric identity. Crafted from dark-stained solid wood, the frame is reinforced with exposed metal rivets at the joints, balancing structural integrity with industrial-inspired detail. A soft off-white upholstered cushion contrasts the rich wood grain, creating a calm, modern seating piece suited for contemporary interiors.

04/

# Nest Sofa

Soft, sculptural seating designed for quiet confort



We curate every piece with intention-choosing quiet elegance over loud trends-to fulfill our ultimate purpose uplifting your lifestyle. Whether it's transforming a premium hospitality lounge into an inspiring retreat, or turning a quiet corner into a sanctuary for physical and mental rejuvenation, our designs actively elevate everyday rituals. This is because true luxury is the quiet harmony of a space that empowers everyone to live beautifully, comfortably, and effortlessly.

A seat is not only for sitting, but for withdrawing





## Enclosure

Inspired by the symbolic image of a "nest," the form becomes semi-enclosed—offering a gentle boundary without full isolation.

Velvet was chosen as the material to provide a comfortable visual and tactile experience, enhancing both the sense of luxury and comfort.

## Fabric



## Quiet Retreat

Enhancing comfort through both visual and tactile appeal, the minimalist design also offers a fresh approach to comfort

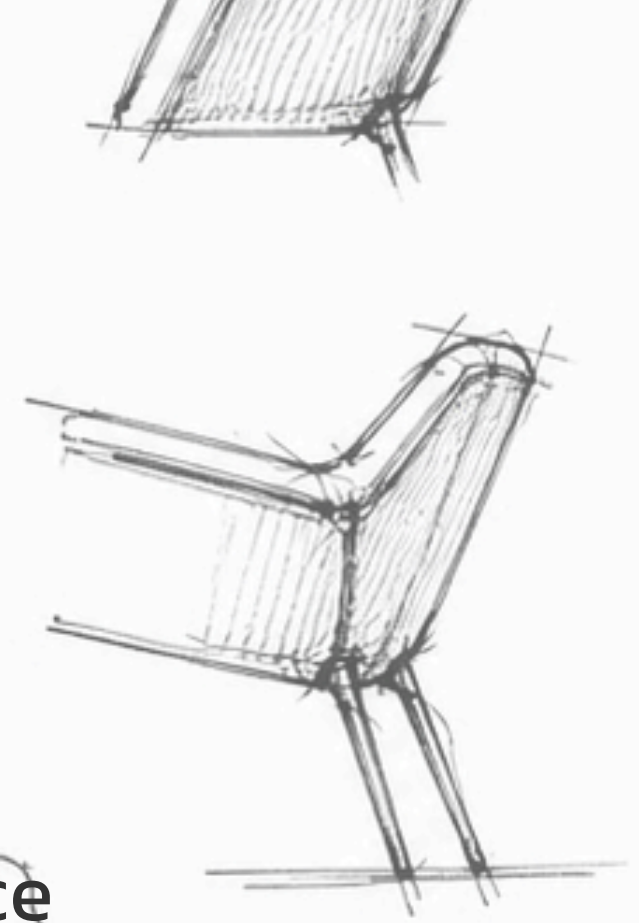
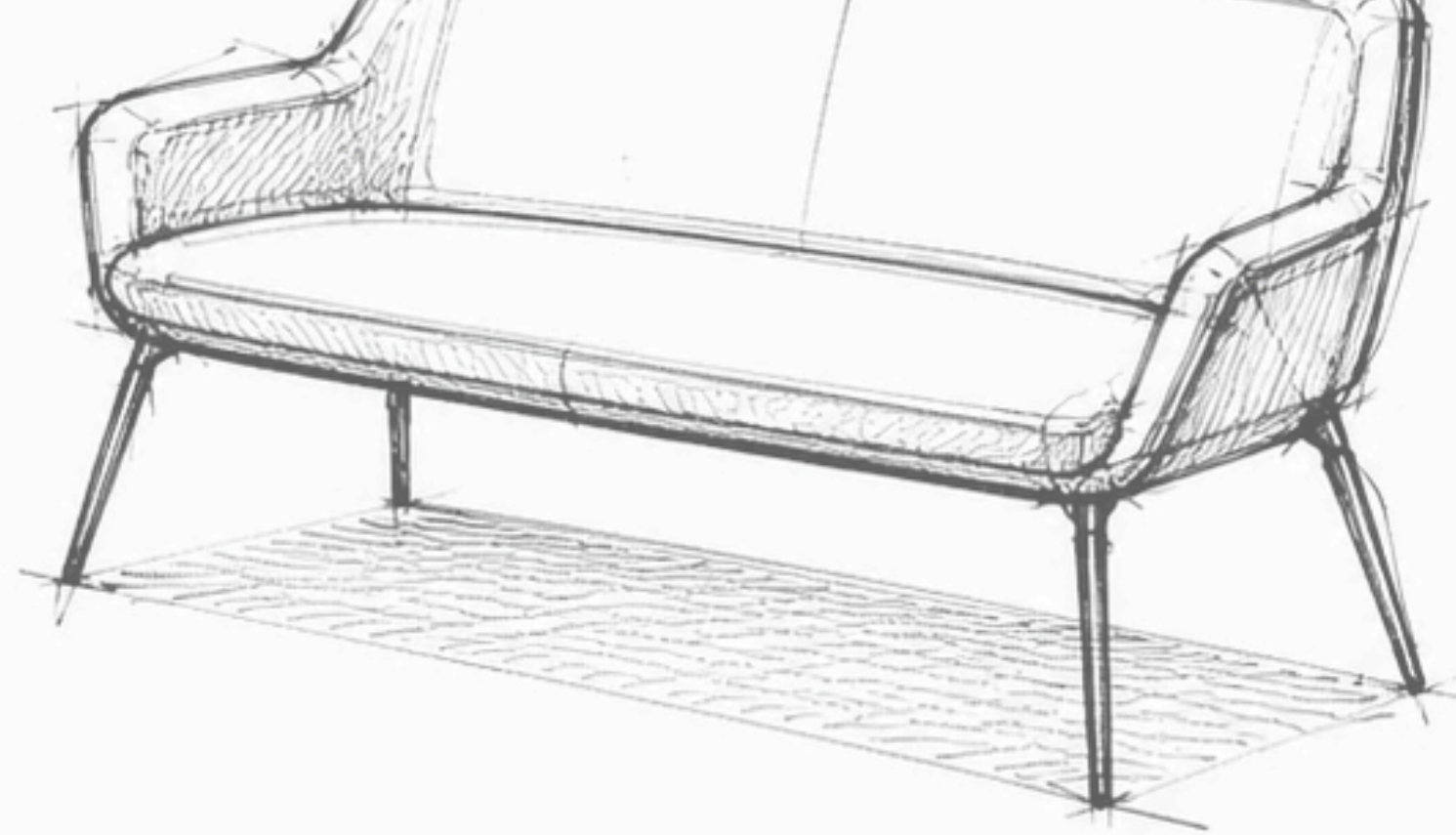

Enclosure, Fabric, Quiet Retreat those always our choice

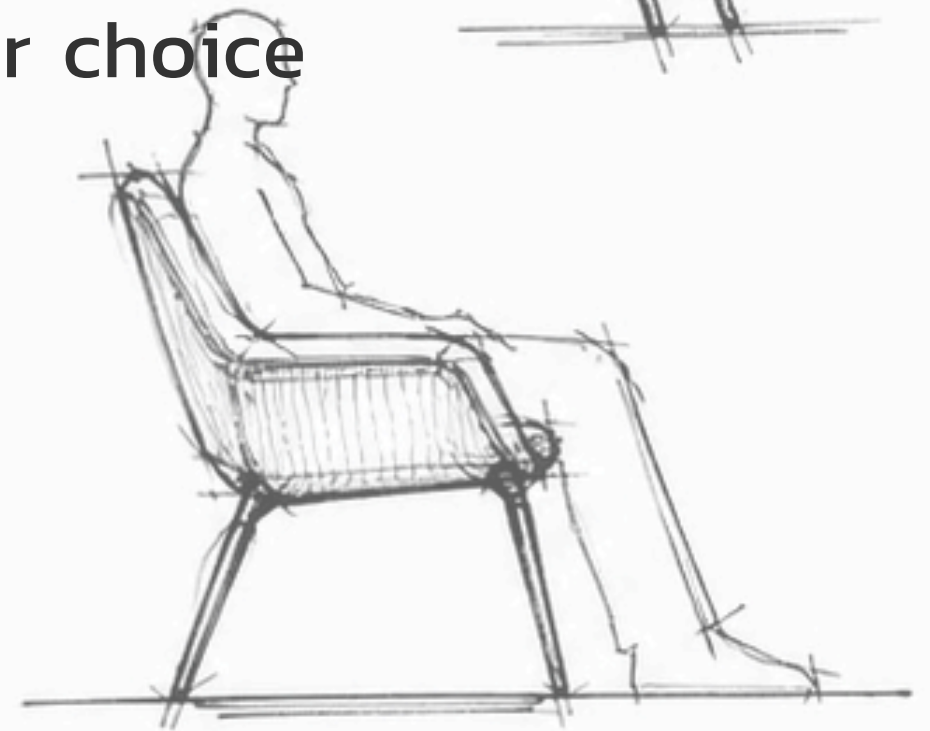
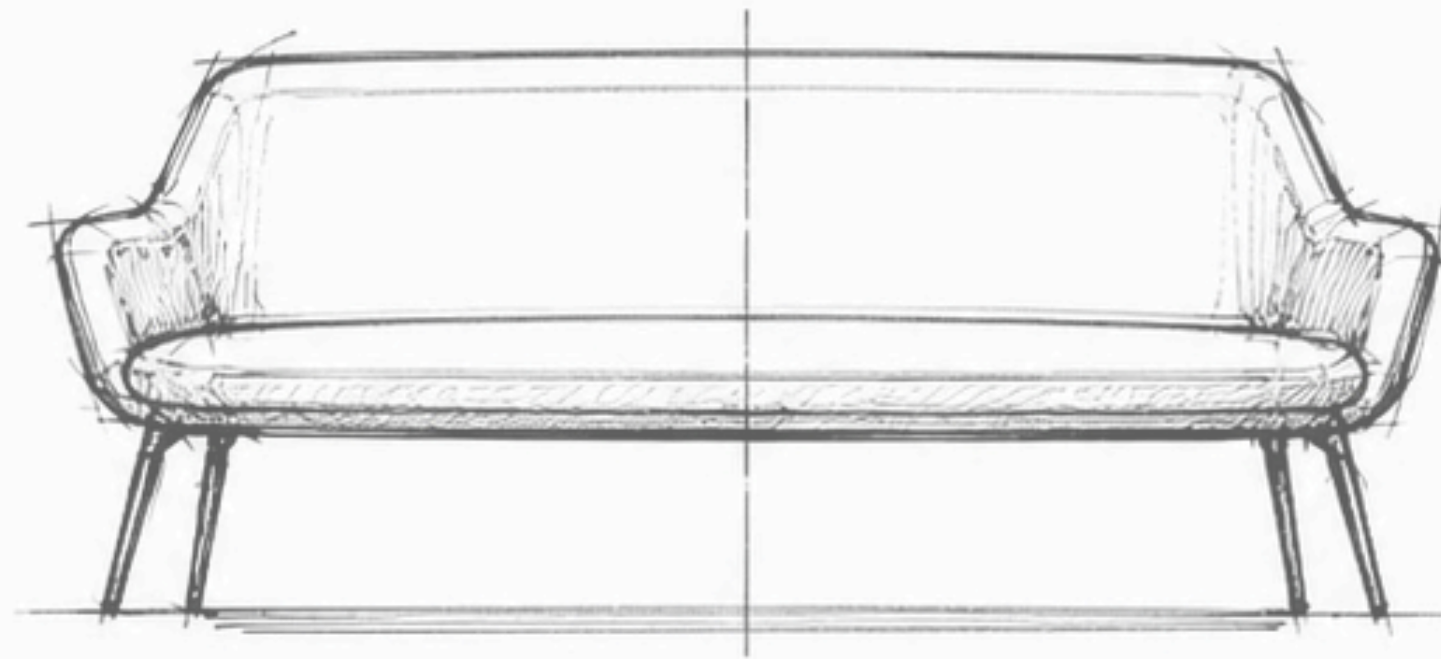
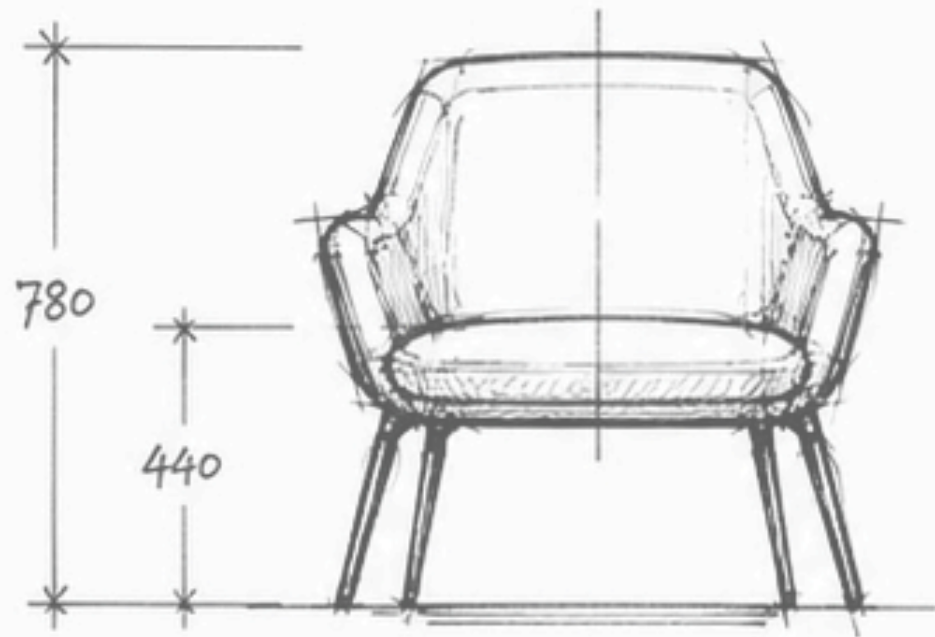

 Spacefriend

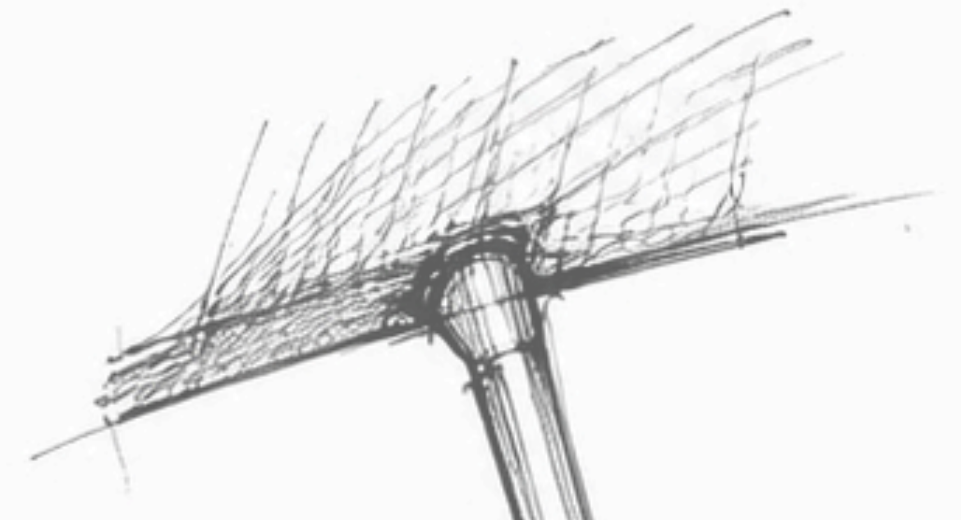
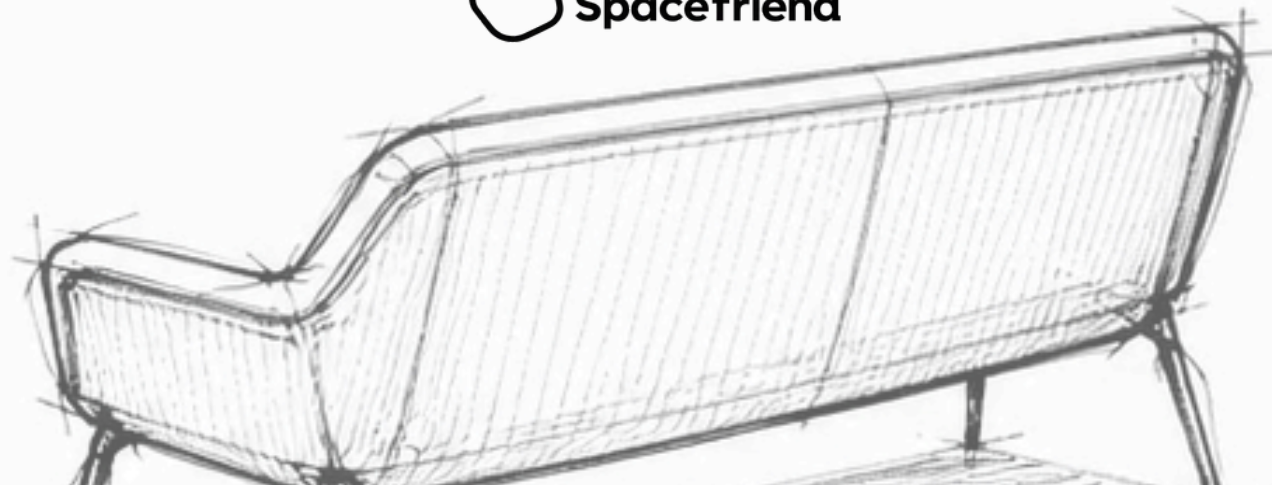



In dense urban environments, moments of rest are often fragmented and lack a sense of psychological enclosure.

People do not only seek physical comfort, but a subtle sense of protection—a space that allows them to withdraw, reset, and feel momentarily held within their surroundings.



001

Nest sofa  
W 170cm D 74cm H 79cm Seat 46cm

001

Nest Armchair  
W 68cm D 74cm H 79cm Seat 46cm





 **Spacefriend**



### Continuous-Form Velvet Seating Set

Placed in a quiet corner of a living room or a compact apartment, the Nest Sofa becomes a personal retreat within the larger space.

Its enveloping form supports moments of pause—reading, resting, or simply disconnecting from the surrounding environment.

Rather than occupying space, it defines a subtle boundary for emotional recovery within everyday life.

# Reflection

- Through these projects, I have come to understand that design is not only about creating objects, but about shaping relationships—between time and behavior, structure and culture, and environment and emotion.
- I began with a focus on form and material clarity, but gradually realized that the deeper value of design lies in how it responds to real conditions of contemporary life—fragmented routines, constrained spaces, and emotional displacement.
- Rather than designing isolated products, I am increasingly interested in creating systems that restore continuity and meaning in everyday experiences.
- Moving forward, I aim to further explore how minimal interventions can generate meaningful impact, especially within urban contexts where time, space, and attention are limited
- Design, to me, is a quiet but powerful tool to reconnect people with their environment—and with themselves.

**Portfolio Ji Jie**

2026

*Ji Jie*